

# P in-Female Header 2.54 mm



RoHS

## Pin Header 2.54mm 1 Row H=2.5mm Press Fit Type

TOPTEK®  
HARDWARE ELECTRONIC MANUFACTURER

www.toptek-co.com

### Specifications

Current Rate: 3 AMP  
 Insulation Resistance: 1000MΩ Min.  
 Contact Resistance: 20mΩ Max.  
 Dielectric Voltage: 1000V AC for one minute  
 Operation Temperature: -40°C to +105°C

### Material

Insulator: Hi-Temp. Thermoplastic, UL 94V-0  
 Terminal: Copper Alloy  
 Plating: Gold Plated

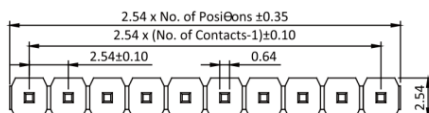

Recommended PCB Layout  
(PCB TOLERANCE ±0.05)

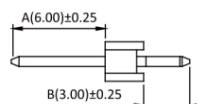
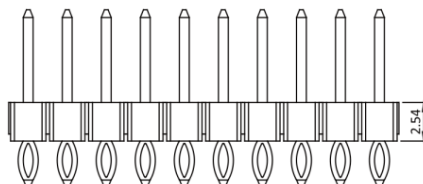

Part No.: PH1FS25-1XX-L

## ORDER INFORMATION

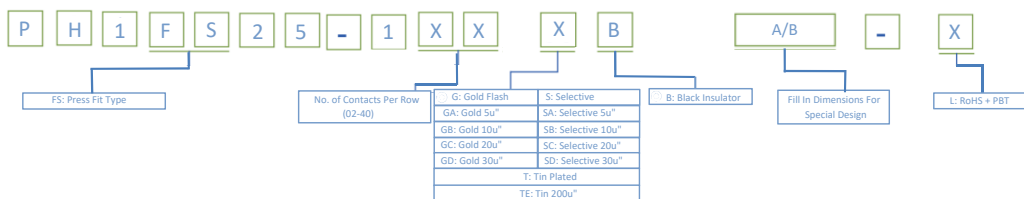

©: Standard Recommend